



# JBL CristalProfi m greenline

Mat filter incl. pump for aquariums of 20 – 80 l

Suitable for:



- Clean and healthy aquarium water: mat filter incl. pump and wide jet water return pipe for aquariums of 20 – 80 l volume
- Easy to install: clean the glass pane, press on the filter at desired position with the water outlet at the water surface level
- Safe for small fish and shrimps: no sucking in thanks to fine sponge surface
- 4 years warranty, expandable with second filter module (+ 12 cm in height), push lever to loosen and tighten the suction cup, easy to clean: removable cover for sponge and drain valve – no backflow of dirty water
- Package contents: mat filter, Cristal Profi m greenline, dimensions (L/H/W): 140/220/90 mm, Incl. clip holder for thermometer

You may also be interested in

You can find a complete overview here: <https://www.jbl.de/qr/60960>



## JBL CristalProfi e401 greenline

External filter for aquariums of 40-120 litres



## JBL CRISTALPROFI e402 greenline

External filter for aquariums from 40-120 litres





# JBL CristalProfi m greenline

## Accessories



**JBL CristalProfi m greenline Module**  
Filter module to extend CristalProfi m



**JBL CP m greenline FilterPad**  
Spare sponge for CristalProfi m internal filter



**JBL CP m greenline FilterPad module**  
Spare filter foam for CristalProfi m module

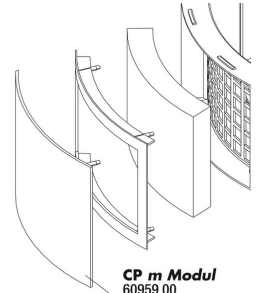

**JBL CP m greenline service cover module**



# JBL CristalProfi m greenline



Spare parts

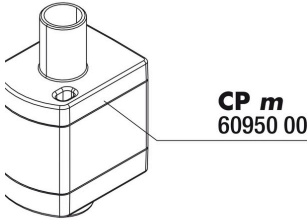

**CP m**  
60950 00

JBL CP m greenline pump



**CP m**  
60951 00

JBL CP m greenline impeller set

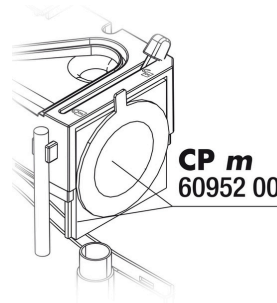

**CP m**  
60952 00

JBL CP m greenline suction cup set

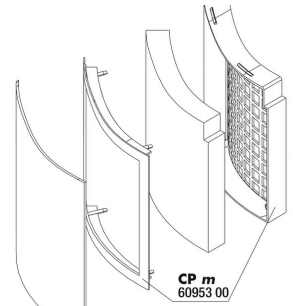

**CP m**  
60953 00

JBL CP m greenline FilterPad holder

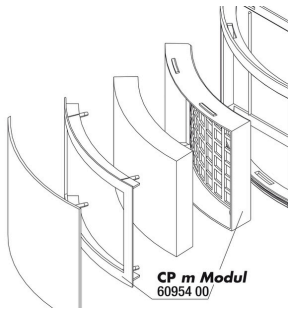

**CP m Modul**  
60954 00

JBL CP m greenline FilterPad module holder

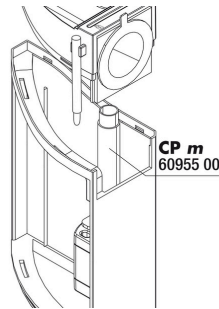

**CP m**  
60955 00

JBL CP m greenline outlet pipe

**CP m**  
60956 00

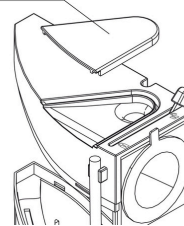

JBL CP m greenline water outlet cover

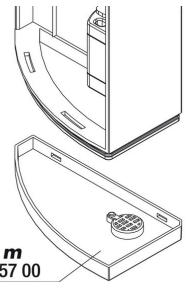

**CP m**  
60957 00

JBL CP m greenline base plate

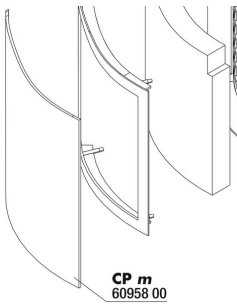

**CP m**  
60958 00

JBL CP m greenline service cover



6348810

JBL adapter UK for all flat-pin plugs



# JBL CristalProfi m greenline



## Product information

### Clean and healthy water

Plant and food remains and metabolic substances lead to a deterioration of the quality of the water in the aquarium. Good water quality is necessary for healthy fish and plants. This can be achieved with aquarium filters. The filters suck in the aquarium water and remove the pollution and waste materials from the water.

### Effective

The JBL CristalProfi is submerged completely in water to clean the aquarium water. A maintenance-free pump built into the lower part of the filter ensures permanent water circulation. The aquarium water flows slowly over a large surface area into the filter pad, where it is cleaned and then pumped back into the aquarium.

### Safe

Thanks to the large sponge surface with its fine pores there is no risk of small fish and shrimps getting sucked in.

### Expandable

The filter can be expanded with a second module (+12 cm in height). JBL grants a guarantee of 4 years.

| Further information   |   |
|-----------------------|---|
| FAQ                   | ✓   |
| Blog                  | ✓   |
| Press                 | ✓   |
| Laboratory/calculator | ✗   |
| Worth reading         | ✓   |
| Spare parts           | ✓   |
| Video                 | ✓   |
| GarantiePlus          | ✓   |
| Instructions          | ✓   |
| QR code               |  |





# JBL CristalProfi m greenline



## Product details

| Article data             |   |
|--------------------------|---|
| Product name             | JBL CristalProfi m greenline  |
| Art. No.                 | 6096000   |
| EAN number               | 4014162609601   |
| EAN as barcode           |  |
| Watt                     | 3,5 W   |
| Performance              | 200 l/h   |
| Expiry months            | -   |
| RRP incl. VAT            | 48,73 €   |
| Base price               | -   |
| Nominal filling quantity | -   |
| Base quantity            | 1   |
| Gross weight             | 677 g   |
| Net weight               | 500 g   |
| Weight change            | 1000  |

| Disposal                |   |
|-------------------------|---|
| Product name            | JBL CristalProfi m greenline                            |
| Art. No.                | 6096000   |
| Green dot               | ✓   |
| Group electronic waste  | Small appliances that can be used in private households |
| Disposal weight         | 191 g   |
| Battery type            | -   |
| Battery return          | -   |
| Battery rechargeable    | -   |
| Disposal weight battery | -   |
| Non-returnable glass    | -   |
| PPK                     | 80 g  |
| Plastic small           | -   |
| Plastic large           | -   |
| Disposal weight metal   | 0 g   |

| Features     |                              |
|--------------|------------------------------|
| Product name | JBL CristalProfi m greenline |
| Art. No.     | 6096000                      |





| Features             |  |
|----------------------|--|
| Animal species       | Armored catfish, Arowana, Axolotl, Barbels, Bettas, Bichirs/ reedfish, Blowfish, Catfish, Cichlids (South America), Clawed frogs, Clawed shrimps, Corals, Crayfish, Crustaceans, Danions, Discus, Dwarf crayfish, Dwarf shrimps, Flowerhorn, Gill maggots, Gobies, Goldfish, Gouramis, Guppy, Juvenile fish, Killifish, Livebearers, Loaches, Mussels, Newts, Panchaxes, Rainbowfish, Snails, Spiny eels, Terrapins, Tetra, Tropical terrapins, Veiltails, blood parrot cichlids, freshwater butterflyfish, turtle |
| Animal size          | 2 - 10 cm  |
| Animal age group     | Small and medium-sized aquarium fish   |
| Volume of habitat    | 20 - 80 (20 - 100 cm)  |
| Material             | plastic (ABS ) / metal (copper)  |
| Food type            | -  |
| Colour               | black  |
| Dosage               | -  |
| Transport conditions | -  |



# JBL CristalProfi m greenline

| Electronic label / illuminant |                              |
|-------------------------------|------------------------------|
| Product name                  | JBL CristalProfi m greenline |
| Art. No.                      | 6096000                      |
| Ambient temperature           | -                            |
| Start time                    | -                            |
| Mercury                       | -                            |
| Tube length                   | -                            |
| Service life                  | -                            |
| Lumen                         | -                            |
| CRI value                     | -                            |
| Dimmable                      | -                            |
| Switching cycles              | -                            |
| PAR value                     | -                            |
| Energy efficiency class       | -                            |
| UV-A                          | -                            |
| UV-B                          | -                            |
| UV-C                          | -                            |
| Colour temperature            | -                            |
| Base designation              | -                            |

| Technical data                |                              |
|-------------------------------|------------------------------|
| Product name                  | JBL CristalProfi m greenline |
| Art. No.                      | 6096000                      |
| Range in litres               | -                            |
| Range from - to               | 20-112l                      |
| Range in days                 | -                            |
| Range tank length             | 100                          |
| Output in watts               | 4 W                          |
| Output per hour               | 200                          |
| Output per day                | -                            |
| Height                        | 190 mm                       |
| Length                        | 128 mm                       |
| Width                         | 65 mm                        |
| Diameter                      | -                            |
| Voltage                       | 230 V                        |
| For                           | -                            |
| T8 26mm (watt)                | -                            |
| T5 16mm (watt)                | -                            |
| Size                          | -                            |
| Content for                   | -                            |
| Filter container volume       | -                            |
| Volume filter media           | 0.35 l                       |
| Hose connections pressure/out | -                            |
| Hose connections suction/in   | -                            |
| Delivery head                 | -                            |





# JBL CristalProfi m greenline

|                  |   |
|------------------|---|
| Food type        | - |
| Sub product type | - |
| Dosing           | - |







## Additional information for the specialist trade sector

| Article data         |                              |
|----------------------|------------------------------|
| Product name         | JBL CristalProfi m greenline |
| Art. No.             | 6096000                      |
| VAT                  | 19%                          |
| Sales unit (SU)      | 2                            |
| Volume packaging     | 2.77l                        |
| Dimensions (l/w/h)   | 90 mm/140 mm/220 mm          |
| Layer                | 48                           |
| Pallet               | 192                          |
| Category of products | 3                            |
| Customs tariff       | 84212100                     |
| Country of origin    | CN                           |
| Type of packaging    | Faltschachtel/Karton         |

| PU 1 data        |                              |
|------------------|------------------------------|
| Product name     | JBL CristalProfi m greenline |
| Art. No.         | 6096000                      |
| PU 1 material    | film gr                      |
| PU 1 weight      | 2 g                          |
| PU 1 length      | 140 mm                       |
| PU 1 width/depth | 180 mm                       |
| PU 1 height      | 220 mm                       |

| PU 2 data        |                              |
|------------------|------------------------------|
| Product name     | JBL CristalProfi m greenline |
| Art. No.         | 6096000                      |
| PU 2 material    | cardboard gr                 |
| PU 2 weight      | 350 g                        |
| PU 2 length      | 310 mm                       |
| PU 2 width/depth | 210 mm                       |
| PU 2 height      | 260 mm                       |

| Trade data        |                              |
|-------------------|------------------------------|
| Product name      | JBL CristalProfi m greenline |
| Art. No.          | 6096000                      |
| Till receipt text | CristalProfi m               |
| Shelf placement   | -                            |

