



JBL PROFLORA m501

CO2 plant fertiliser system complete kit

Suitable for:



- CO2 fertiliser system with refillable cylinder for the best feeding of fast and slow growing plants in freshwater aquariums up to 400 l
- Assemble system, attach diffuser in the aquarium and adjust CO2 supply until the permanent test indicates the ideal value
- Professional water care: precise dosing due to pressure reducer. Even release. Effective distribution due to extendable diffuser. Best check of CO2: bubble counter with magnifying part and CO2/pH test. Residual pressure display on pressure gauge
- TÜV tested storage cylinder, pressure cylinder with overpressure relief, stand ensures cylinder does not fall over. Hose screw connection prevents hose from slipping, check valve prevents water entering the cylinder
- Package contents: refillable 500g CO2 cylinder, stand, pressure reducer, diffuser JBL Taifun 27 cm, bubble counter, 3 m special hose, backflow stop, CO2/pH permanent test, 2x liquid fertiliser and 1x daily fertiliser

You may also be interested in

You can find a complete overview here: <https://www.jbl.de/qr/63183>



JBL PROFLORA u501
 Plant fertiliser system complete kit



JBL PROFLORA u502
 Plant fertiliser system with night switch-off



JBL PROFLORA Bio80 eco
 Bio-CO2 fertiliser system



JBL PROFLORA Bio80
 Bio-CO2 fertiliser system with glass diffuser





JBL PROFLORA m501

Accessories



JBL Suction cup with clip 37 mm
 Rubber suction cup with clip for objects of 37-45 mm



JBL PROFLORA Direct
 High performance direct diffuser for CO₂



JBL PROFLORA m500 SILVER
 Refillable storage cylinder with 500 g CO₂



JBL PROFLORA m2000 SILVER
 Refillable storage cylinder with 2 kg CO₂



JBL PROFLORA pH-Control Touch
 Measurement and control computer for control of CO₂/pH



JBL PROFLORA CO₂ Count Safe
 Bubble counter with backflow stop



JBL PROFLORA SafeStop
 Water backflow stop for CO₂ systems



JBL PROFLORA T3
 Special hose for CO₂ systems in aquariums



JBL PROFLORA stand CO₂ storage cylinder 500 g
 Stand for cylinders of CO₂ fertiliser systems



JBL PROFLORA m001
 Fitting to reduce pressure



JBL PROFLORA v002
 Noiseless solenoid valve



JBL PROFLORA Taifun Extend
 Extension for CO₂ high-performance diffuser





JBL PROFLORA m501

Accessories



JBL PROFLORA Taifun M
CO2 high-performance diffuser



JBL PROFLORA Taifun S
Extendable CO2 diffuser for
small aquariums



JBL PROFLORA Taifun P
Mini CO2 diffuser for nano
freshwater aquariums

**JBL PROFLORA CO2
refill 500g**



JBL PROFLORA m501

Spare parts

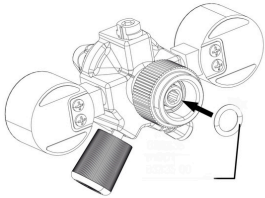

JBL ProFlora "m" O-ring

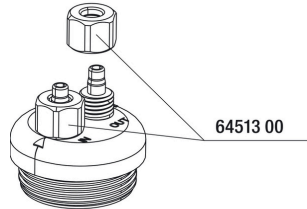

JBL Cap Nut Air/CO₂ hose

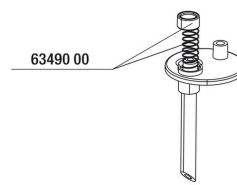

JBL CO₂ Count safe spring + seal

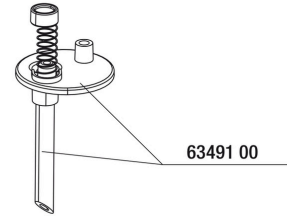

JBL CO₂ Count safe retaining plate

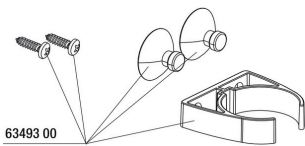

JBL CO₂ Count safe holder kit

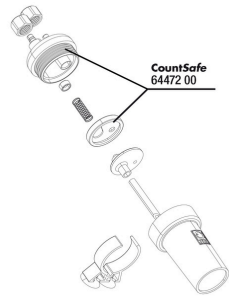

JBL CO₂ Count safe seal plate



JBL CO₂ Permanent colour charts

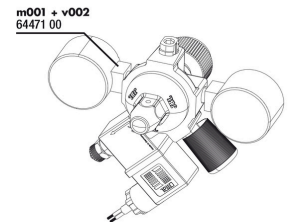

JBL ProFlora m001+v002



JBL ProFlora Allen key 6mm

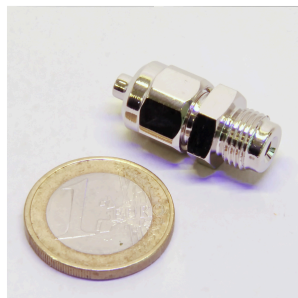

JBL tube screw connection 4/6 pressure reducer





JBL PROFLORA m501



Product information

Nutrition for aquarium plants

Plants provide the aquarium with vital oxygen for the aquarium dwellers, prevent algae growth, remove pollutants, provide hiding places and reduce pathogens. The JBL plant fertiliser systems supply the plants with the main nutrient CO2 through the water. They absorb this through their leaves.

Easy to install

The system comes completely ready for connection. Screw the pressure reducer onto the CO2 storage cylinder. Connect the pressure reducer with the hose to the diffuser in the aquarium. The CO2 enters the aquarium and is dissolved in the water by the diffuser. The CO2 supply can be interrupted at night by adding a solenoid valve (not included).

Safe

The storage cylinder is TÜV tested and is equipped with an overpressure relief. Thanks to the check valve no water can enter the cylinder. The enclosed stand prevents the cylinder from falling over. The capacity of a CO2 system depends on various factors. The carbonate hardness, the quantity and species of the plants and the strength of the water surface movement are decisive. A 500 g cylinder which is not switched off by a solenoid valve during the night lasts with its default adjustment for about 4 months.

| Further information | |
|-----------------------|---|
| FAQ | ✓ |
| Blog | ✓ |
| Press | ✓ |
| Laboratory/calculator | ✗ |
| Worth reading | ✓ |
| Spare parts | ✓ |
| Video | ✓ |
| GarantiePlus | ✗ |
| Instructions | ✓ |
| QR code |  |





JBL PROFLORA m501

| | |
|------------------|---|
| Food type | - |
| Sub product type | - |
| Dosing | - |





JBL PROFLORA m501



Safety information

| - safety information in accordance with GHS | |
|---|--|
| Signal word | Warning |
| Hazard symbol | |
| Risk phrase | H280: Contains gas under pressure; may explode if heated. |
| safety note | P101: If medical advice is needed, have product container or label at hand. P102: Keep out of reach of children. P103: Read label before use. P410+P403: Protect from sunlight. Store in a well-ventilated place. |

| Further safety information | |
|----------------------------|---|
| Safety instructions | ✓ |
| QR code | |

