



JBL AutoFood WHITE

White automatic feeder for aquarium fish

Suitable for:



- Practical automatic feeder: automatic feeding of aquarium fish – For all granulates up to 3 mm
- Easy setting: up to 4 feeds per day with individual food quantities. Holds up to 375 ml.
- On/Off switch for manual operation, easy adjustment of feeding times and quantity
- Air connection to keep the food dry, universal mounting with suction cups or mounting clamps (can rotate 360° on the mount)
- Package contents: automatic feeder for aquarium fish with mounts and 3x 1.5 V AA batteries

You may also be interested in

You can find a complete overview here: <https://www.jbl.de/qr/60616>



JBL Cooler 100
 Cooling fan for fresh- and saltwater aquariums



JBL CoolControl
 Thermostat to regulate cooling fan





JBL AutoFood WHITE

Spare parts



Complete suction cup set (2x) for JBL Autofood

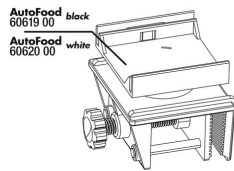

Complete holder kit for JBL Autofood

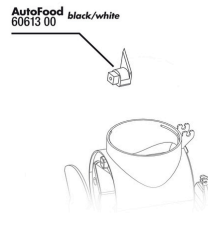

JBL Autofood Knife for tin sealing

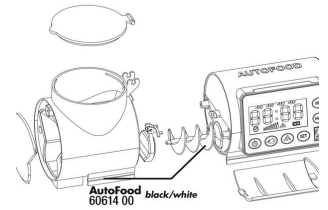

JBL Autofood Auger



JBL AutoFood transparent food container set

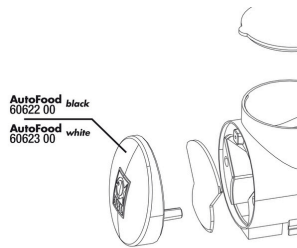

JBL AutoFood End cap

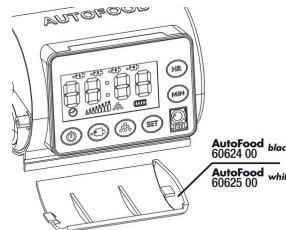

JBL AutoFood Battery compartment lid

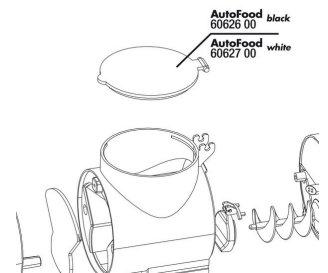

JBL AutoFood Food Chamber Lid



JBL AutoFood WHITE



Product information

Automatic Feeding

JBL's practical automatic feeder enables the automatic feeding of aquarium fish. The automatic device is suitable for all granulates up to 3 mm.

Feeds up to 4 times a day

AutoFood can be set for up to 4 feeds a day. The device has an On/Off switch for the manual operation. The feeding times and the quantity can easily be set on the display. AutoFood has an air connection to keep the food dry.

Easy to mount

The automatic device can be attached by suction cups or a stable clamp mounting. The mount can be rotated by 360 degrees.

Further information	
FAQ	✓
Blog	✓
Press	✓
Laboratory/calculator	✗
Worth reading	✓
Spare parts	✓
Video	✓
GarantiePlus	✗
Instructions	✓
QR code	





JBL AutoFood WHITE

Food type	-
Sub product type	-
Dosing	-

