



JBL PROFLORA m2003

Plant fertiliser system & 2 kg cylinder & pH control

Suitable for:



- CO2 fertiliser system with pH control device for the automatic feeding of fast and slow growing plants in freshwater aquariums up to 1000 l
- Easy to use and efficient: refillable 2 kg cylinder. Simple assembly, no separate water pump required, convertible into disposable system
- Professional water care, automatic control: exact dosing with pressure reducer, even release, effective distribution thanks to expandable diffuser. Check: bubble counter with check valve. Residual pressure display on pressure gauge
- TÜV tested storage cylinder with overpressure relief. Stand prevents cylinder from falling over. Hose screw connection prevents hose from slipping, check valve prevents water entering the cylinder
- Package content: 2 kg CO2 cylinder, pressure reducer, pH controller (pH sensor not included), diffuser, bubble counter, hose, backflow stop, liquid fertiliser, daily fertiliser

You may also be interested in

You can find a complete overview here: <https://www.jbl.de/qr/63186>



JBL PROFLORA u501
 Plant fertiliser system complete kit



JBL PROFLORA u502
 Plant fertiliser system with night switch-off



JBL PROFLORA Bio80 eco
 Bio-CO2 fertiliser system



JBL PROFLORA Bio80
 Bio-CO2 fertiliser system with glass diffuser





JBL PROFLORA m2003

Accessories



JBL CO2 Refill Service
 Refill service for the filling of
 JBL CO2 cylinders



**JBL Suction cup with
 clip 37 mm**
 Rubber suction cup with clip
 for objects of 37-45 mm



JBL PROFLORA Direct
 High performance direct
 diffuser for CO2



**JBL PROFLORA m500
 SILVER**
 Refillable storage cylinder with
 500 g CO2



**JBL PROFLORA m2000
 SILVER**
 Refillable storage cylinder with
 2 kg CO2



**JBL PROFLORA pH-
 Control Touch**
 Measurement and control
 computer for control of CO2/
 pH



**JBL PROFLORA Taifun
 Extend**
 Extension for CO2 high-
 performance diffuser



**JBL PROFLORA Taifun
 M**
 CO2 high-performance diffuser



JBL PROFLORA Taifun S
 Extendable CO2 diffuser for
 small aquariums



JBL PROFLORA Taifun P
 Mini CO2 diffuser for nano
 freshwater aquariums





JBL PROFLORA m2003

Spare parts



JBL slotted suction cup, 2mm
 Holder for heating cables in aquariums and terrariums

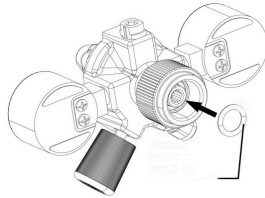

JBL ProFlora "m" O-ring

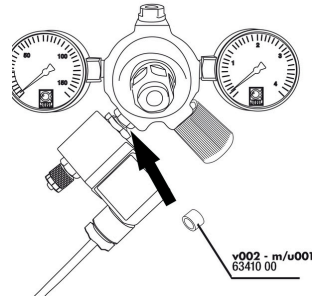

JBL ProFlora "u/m" flat seal



6348810

JBL adapter UK for all flat-pin plugs

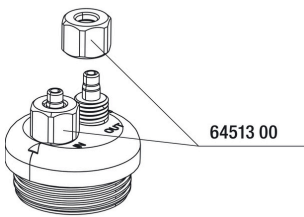

JBL Cap Nut Air/CO₂ hose

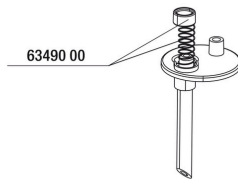

63490 00

JBL CO₂ Count safe spring + seal

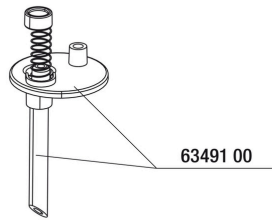

63491 00

JBL CO₂ Count safe retaining plate

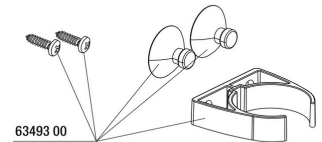

63493 00

JBL CO₂ Count safe holder kit

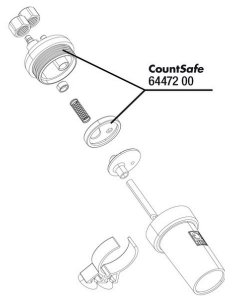

CountSafe
64472 00

JBL CO₂ Count safe seal plate



JBL CO₂ Permanent colour charts

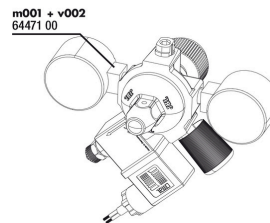

m001 + v002
64471 00

JBL ProFlora m001+v002

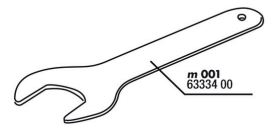

m 001
63534 00

JBL ProFlora open-end spanner





JBL PROFLORA m2003



Spare parts



JBL ProFlora Allen key
6mm



JBL tube screw
connection 4/6
pressure reducer



JBL pH Control
temperature sensor



JBL pH Control Touch
connection cable



JBL PROFLORA m2003



Product information

Nutrition for aquarium plants

Plants provide the aquarium with vital oxygen for the aquarium dwellers, prevent algae growth, remove pollutants, provide hiding places and reduce pathogens. The JBL plant fertiliser systems supply the plants with the main nutrient CO₂ through the water. They absorb this through their leaves.

Easy to install

The system comes completely ready for connection. Screw the pressure reducer onto the CO₂ storage cylinder. Connect the pressure reducer with the hose to the pH controller and from there over the bubble counter/check valve to the diffuser in the aquarium. The CO₂ enters the aquarium and is dissolved in the water by the diffuser.

Safe

The storage cylinder is TÜV tested and is equipped with an overpressure relief. Thanks to the check valve no water can enter the cylinder. The enclosed stand prevents the cylinder from falling over. The capacity of a CO₂ system depends on various factors. The carbonate hardness, the quantity and species of the plants and the strength of the water surface movement are decisive. A 500 g cylinder in its default setting lasts for about 4 months.

Why isn't the pH sensor (electrode) included?

This is because of the lifetime of the electrode. The CO₂ system is not necessarily sold as soon as the specialist dealer receives it: it can sometimes stay on the shelf for some time. If the pH electrode were part of it, it would age unused during this time. Since the service life is about 2 years after production we want to make sure that the user always gets a brand-new sensor, so we sell it separately.

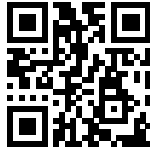
Further information	
FAQ	✓
Blog	✓
Press	✓
Laboratory/calculator	✗
Worth reading	✓
Spare parts	✓
Video	✓
GarantiePlus	✗
Instructions	✓
QR code	





JBL PROFLORA m2003

Food type	-
Sub product type	-
Dosing	-





JBL PROFLORA m2003



Safety information

- safety information in accordance with GHS	
Signal word	Warning
Hazard symbol	
Risk phrase	H280: Contains gas under pressure; may explode if heated.
safety note	P101: If medical advice is needed, have product container or label at hand. P102: Keep out of reach of children. P103: Read label before use. P410+P403: Protect from sunlight. Store in a well-ventilated place.

Further safety information	
Safety instructions	✓
QR code	

