



# JBL PROFLORA m502

CO2 plant fertiliser system with night switch-off

Suitable for:



- CO2 fertiliser system for the best feeding of fast and slow growing plants in freshwater aquariums up to 600 l
- Assemble system, attach diffuser in the aquarium and adjust CO2 supply until the permanent test indicates the ideal value
- Professional water care with night switch-off: precise dosing thanks to pressure reducer, even release, effective distribution due to extendable diffuser, best control due to bubble counter, CO2/pH test, residual pressure display on pressure gauge
- Refillable cylinder with overpressure relief, TÜV tested. Stand ensures cylinder does not fall over. Hose screw connection prevents hose from slipping, check valve prevents water entering the cylinder
- Package contents: refillable 500g CO2 cylinder, fitting, stand, pressure reducer, night switch-off (time switch sold separately), diffuser, bubble counter, 3 m hose, backflow stop, CO2/pH test, liquid fertiliser & daily fertiliser

You may also be interested in

You can find a complete overview here: <https://www.jbl.de/qr/63184>



**JBL PROFLORA u501**  
 Plant fertiliser system complete kit



**JBL PROFLORA u502**  
 Plant fertiliser system with night switch-off



**JBL PROFLORA Bio80 eco**  
 Bio-CO2 fertiliser system



**JBL PROFLORA Bio80**  
 Bio-CO2 fertiliser system with glass diffuser





# JBL PROFLORA m502

## Accessories



**JBL Suction cup with clip 37 mm**  
 Rubber suction cup with clip for objects of 37-45 mm



**JBL PROFLORA Direct**  
 High performance direct diffuser for CO<sub>2</sub>



**JBL PROFLORA m500 SILVER**  
 Refillable storage cylinder with 500 g CO<sub>2</sub>



**JBL PROFLORA m2000 SILVER**  
 Refillable storage cylinder with 2 kg CO<sub>2</sub>



**JBL PROFLORA pH-Control Touch**  
 Measurement and control computer for control of CO<sub>2</sub>/pH



**JBL PROFLORA CO<sub>2</sub> Count Safe**  
 Bubble counter with backflow stop



**JBL PROFLORA SafeStop**  
 Water backflow stop for CO<sub>2</sub> systems



**JBL PROFLORA T3**  
 Special hose for CO<sub>2</sub> systems in aquariums



**JBL PROFLORA stand CO<sub>2</sub> storage cylinder 500 g**  
 Stand for cylinders of CO<sub>2</sub> fertiliser systems



**JBL PROFLORA m001**  
 Fitting to reduce pressure



**JBL PROFLORA v002**  
 Noiseless solenoid valve



**JBL PROFLORA Taifun Extend**  
 Extension for CO<sub>2</sub> high-performance diffuser





# JBL PROFLORA m502

## Accessories



**JBL PROFLORA Taifun M**  
CO2 high-performance diffuser



**JBL PROFLORA Taifun S**  
Extendable CO2 diffuser for  
small aquariums



**JBL PROFLORA Taifun P**  
Mini CO2 diffuser for nano  
freshwater aquariums

**JBL PROFLORA CO2  
refill 500g**



# JBL PROFLORA m502

## Spare parts

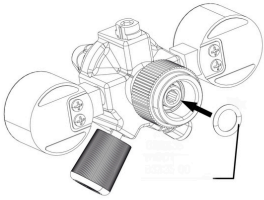

JBL ProFlora "m" O-ring

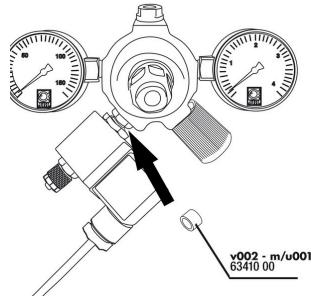

JBL ProFlora "u/m" flat seal



JBL adapter UK for all flat-pin plugs

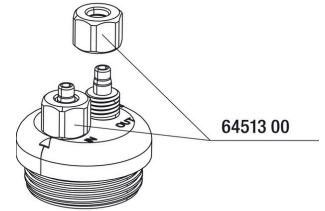

JBL Cap Nut Air/CO<sub>2</sub> hose

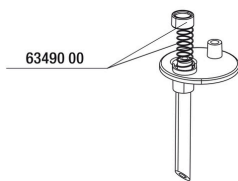

JBL CO<sub>2</sub> Count safe spring + seal

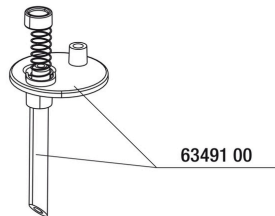

JBL CO<sub>2</sub> Count safe retaining plate

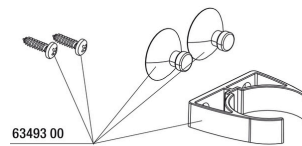

JBL CO<sub>2</sub> Count safe holder kit

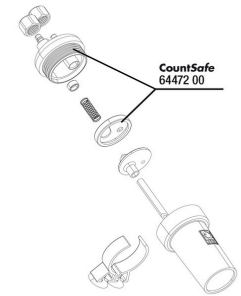

JBL CO<sub>2</sub> Count safe seal plate



JBL CO<sub>2</sub> Permanent colour charts

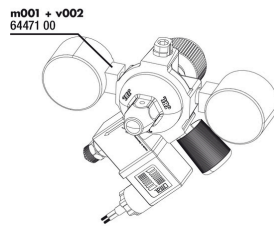

JBL ProFlora m001+v002



JBL ProFlora Allen key 6mm

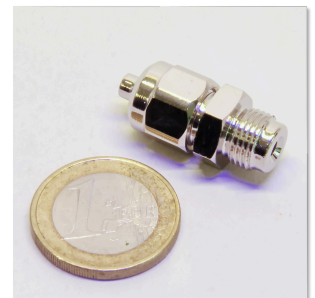

JBL tube screw connection 4/6 pressure reducer





# JBL PROFLORA m502



## Product information

### Nutrition for aquarium plants

Plants provide the aquarium with vital oxygen for the aquarium dwellers, prevent algae growth, remove pollutants, provide hiding places and reduce pathogens. The JBL plant fertiliser systems supply the plants with the main nutrient CO2 through the water. They absorb this through their leaves.

### Easy to install

The system comes completely ready for connection. Screw the pressure reducer onto the CO2 storage cylinder. Connect the pressure reducer with the hose to the diffuser in the aquarium. The CO2 enters the aquarium and is dissolved in the water by the diffuser. The CO2 supply can be interrupted at night by adding a solenoid valve.

### Safe

The storage cylinder is TÜV tested and is equipped with an overpressure relief. Thanks to the check valve no water can enter the cylinder. The enclosed stand prevents the cylinder from falling over. The capacity of a CO2 system depends on various factors. The carbonate hardness, the quantity and species of the plants and the strength of the water surface movement are decisive. A 500 g cylinder which is not switched off by a solenoid valve during the night lasts with its default adjustment for about 4 months.

Further information	
FAQ	✓
Blog	✓
Press	✓
Laboratory/calculator	✗
Worth reading	✓
Spare parts	✓
Video	✓
GarantiePlus	✗
Instructions	✓
QR code	





# JBL PROFLORA m502

Food type	-
Sub product type	-
Dosing	-





# JBL PROFLORA m502



## Safety information

- safety information in accordance with GHS	
Signal word	Warning
Hazard symbol	
Risk phrase	H280: Contains gas under pressure; may explode if heated.
safety note	P101: If medical advice is needed, have product container or label at hand. P102: Keep out of reach of children. P103: Read label before use. P410+P403: Protect from sunlight. Store in a well-ventilated place.

Further safety information	
Safety instructions	✓
QR code	

