



# JBL PROFLORA u501

Plant fertiliser system complete kit

Suitable for:



- CO2 fertiliser system for best feeding of fast and slow growing plants in freshwater aquariums up to 400 l (max. 120 cm)
- Assemble system, attach diffuser in the aquarium and adjust CO2 supply that way that the permanent test indicates optimum value
- Professional water care: precise dosing with pressure reducer. Even release, effective distribution due to extendable diffuser. Monitoring: bubble counter with backflow stop and CO2/pH test. Residual pressure display on pressure gauge
- A hose screw connection means the hose cannot slip, a check valve prevents water entering the cylinder
- Package contents: ProFlora u501, incl. disposable 500g CO2 cylinder, fitting, pressure reducer, diffuser JBL Taifun, bubble counter, 3 m special hose, backflow stop, permanent test CO2/pH, 2x 100 ml liquid fertiliser, 1x JBL daily fertiliser

You may also be interested in

You can find a complete overview here: <https://www.jbl.de/qr/63181>



**JBL PROFLORA m501**  
 CO2 plant fertiliser system complete kit



**JBL PROFLORA m502**  
 CO2 plant fertiliser system with night switch-off



**JBL PROFLORA m503**  
 Aquarium plant fertiliser system with pH control



**JBL PROFLORA m2003**  
 Plant fertiliser system & 2 kg cylinder & pH control





# JBL PROFLORA u501

## Accessories



**JBL Suction cup with clip 37 mm**  
 Rubber suction cup with clip for objects of 37-45 mm



**JBL PROFLORA Direct**  
 High performance direct diffuser for CO<sub>2</sub>



**JBL PROFLORA pH-Control Touch**  
 Measurement and control computer for control of CO<sub>2</sub>/pH



**JBL PROFLORA Adapt u-m**  
 Conversion adapter for the change over from disposable to refillable cylinder system



**JBL PROFLORA 3 x u500**  
 CO<sub>2</sub> disposable storage cylinder



**JBL PROFLORA u500**  
 500 g disposable CO<sub>2</sub> storage cylinder



**JBL PROFLORA CO<sub>2</sub> Count Safe**  
 Bubble counter with backflow stop



**JBL PROFLORA SafeStop**  
 Water backflow stop for CO<sub>2</sub> systems



**JBL PROFLORA T3**  
 Special hose for CO<sub>2</sub> systems in aquariums



**JBL PROFLORA v002**  
 Noiseless solenoid valve



**JBL PROFLORA Taifun Extend**  
 Extension for CO<sub>2</sub> high-performance diffuser



**JBL PROFLORA Taifun M**  
 CO<sub>2</sub> high-performance diffuser





# JBL PROFLORA u501

## Accessories



**JBL PROFLORA Taifun S**  
Extendable CO2 diffuser for  
small aquariums



**JBL PROFLORA Taifun P**  
Mini CO2 diffuser for nano  
freshwater aquariums



# JBL PROFLORA u501

## Spare parts



JBL ProFlora "u" flat seal



JBL Cap Nut Air/CO<sub>2</sub> hose

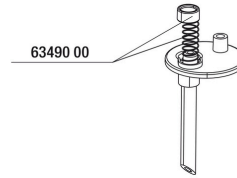

JBL CO<sub>2</sub> Count safe spring + seal

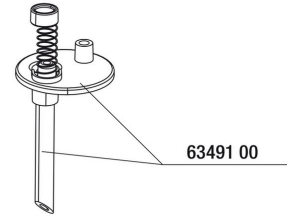

JBL CO<sub>2</sub> Count safe retaining plate

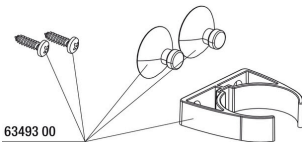

JBL CO<sub>2</sub> Count safe holder kit

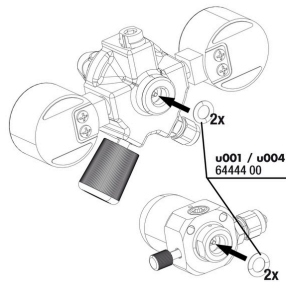

JBL ProFlora "u" O-ring seal

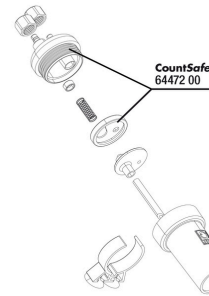

JBL CO<sub>2</sub> Count safe seal plate



JBL CO<sub>2</sub> Permanent colour charts

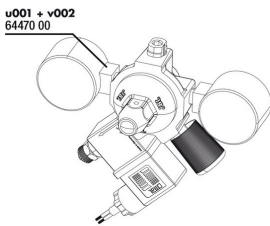

JBL ProFlora u001+v002



JBL ProFlora Allen key 6mm

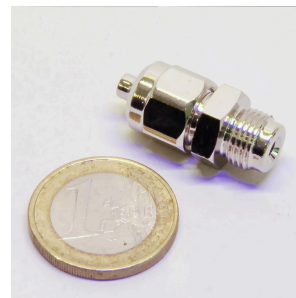

JBL tube screw connection 4/6 pressure reducer





# JBL PROFLORA u501



## Product information

### Nutrition for aquarium plants

Plants supply the aquarium with vital oxygen for your aquarium inhabitants, they prevent algae growth, remove pollutants, provide hiding places and reduce pathogens. The JBL plant fertiliser system supplies the plants with their main nutrient CO2 through the water. The plants absorb this through their leaves.

### Easy to install

The system comes completely ready to connect. Screw the pressure reducer onto the CO2 storage cylinder. Use the hose to connect the pressure reducer to the diffuser in the aquarium. CO2 thus enters the aquarium and is dissolved in the water with the help of the diffuser. The CO2 supply can be interrupted at night by adding an interposed solenoid valve (not included).

### Safe

Thanks to the check valve no water can enter the cylinder. The capacity of a CO2 system depends on various factors. The carbonate hardness, the quantity and species of the plants and the strength of the water surface movement are decisive. A 500 g cylinder which is not switched off by a solenoid valve during the night lasts for about 4 months on its default adjustment.

Further information	
FAQ	✓
Blog	✓
Press	✓
Laboratory/calculator	✗
Worth reading	✓
Spare parts	✓
Video	✓
GarantiePlus	✗
Instructions	✓
QR code	





# JBL PROFLORA u501

Food type	-
Sub product type	-
Dosing	-





# JBL PROFLORA u501

## Safety information

- safety information in accordance with GHS	
Signal word	Warning
Hazard symbol	
Risk phrase	H280: Contains gas under pressure; may explode if heated.
safety note	P101: If medical advice is needed, have product container or label at hand. P102: Keep out of reach of children. P103: Read label before use. P410+P403: Protect from sunlight. Store in a well-ventilated place.

Further safety information	
Safety instructions	✓
QR code	